



# DC MOTOR

2 watt

Graphite Brushes

2-22/02\_ \_

TRIDENT ENGINEERING LIMITED  
Trident House, King Street Lane,  
Winnersh, Wokingham,  
Berkshire, RG41 5AS

Telephone: 0118 978 6444

Fax: 0118 977 6345

Email: sales@tridenteng.co.uk

www.tridenteng.co.uk

### Stock Voltages

		06	12	24
1. Nominal voltage	Volt	6	12	24
2. No-load speed	rpm	4200	5750	7660
3. No-load current	mA	40	30	30
4. Nominal Torque	mNm	2	3	4
5. Starting torque	mNm	10	13	17
6. Torque constant	mNm/A	13.2	19.5	29.0
7. Nominal Speed	rpm	3380	4440	5900
8. Nominal Current	mA	174	170	156
9. Terminal Resistance	Ohm	7.6	17.5	39.3
10. Rotor Inductance	mH	0.5	1.0	2.1
11. Rotor Moment of Inertia	kgm <sup>2</sup>	0.3x10 <sup>-6</sup>	0.3x10 <sup>-6</sup>	0.3x10 <sup>-6</sup>
12. Mechanical time constant	ms	13	14	14
13. Ambient temp. range operating	°C	-10/+65		
14. Thermal resistance winding-housing	K/W	8	8	8
15. Weight	gram	70		
16. Bearings type		sleeve		

### Product combinations

Gearheads GP22, GPP22, GS30, GS38

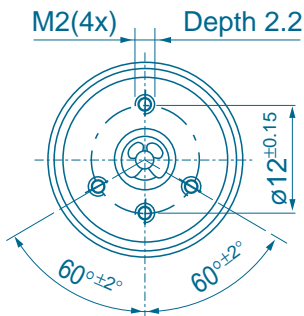

M2x2.2dp on a pcd of 12mm

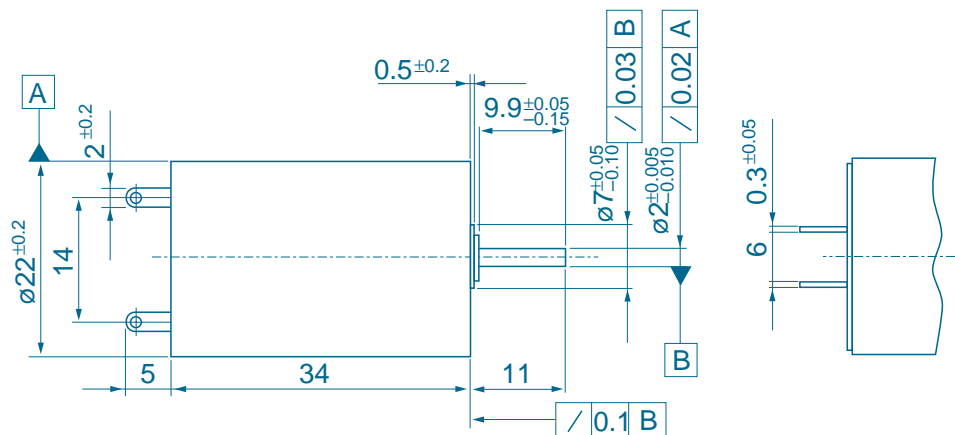

### Notes

