



PLANETARY GEARHEAD

Metal Version

GP42._ _ _ _

TRIDENT ENGINEERING LIMITED
Trident House, King Street Lane,
Winnersh, Wokingham,
Berkshire, RG41 5AS

Telephone: 0118 978 6444

Fax: 0118 977 6345

Email: sales@tridenteng.co.uk

www.tridenteng.co.uk

General data					Product combinations			
Planetary gearhead			straight teeth		Escap 35NT2R32			
Bearing at output			ball bearing		Escap 35NT2R82			
Radial play, 15 mm from flange			0.02	mm				
Axial play			max 0.05	mm				
Max. perm. radial load, 12.5 mm from flange			294	N				
Max. perm. axial load			294	N				
Max. perm. force for press fits			294	N				
Backlash no load per stage			<0.7	°				
Recommended input speed			<5000	rpm				
Recommended temperature range			-20/+80	°C				
Gearhead Order No	Ratio reduction	Exact ratio	Number of stages	Efficiency [%]	Maximum torque continuous [Nm]	Maximum torque intermittent [Nm]	Weight [g]	L1 [mm]
GP42.0004	4.33:1	13/3	1	85	2.94	5.88	415	72.50
GP42.0015	14.9:1	729/49	2	75	7.84	11.76	560	94.00
GP42.0023	23.16:1	162/7	2	75	7.84	11.76	560	94.00
GP42.0036	36:1	36	2	75	7.84	11.76	560	94.00
GP42.0072	72.38:1	507/7	3	68	14.70	24.50	720	115.50
GP42.0100	100.28:1	702/7	3	68	14.70	24.50	720	115.50
GP42.0156	156:1	156	3	68	14.70	24.50	720	115.50
GP42.0216	216:1	216	3	68	14.70	24.50	720	115.50

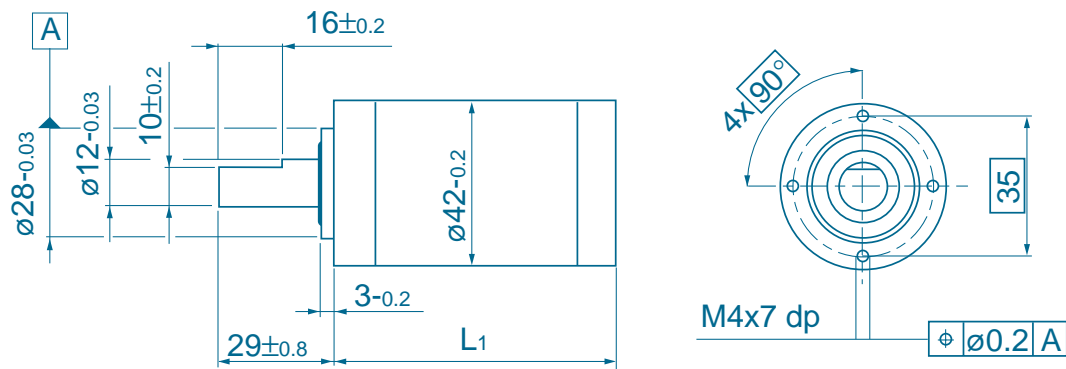

Notes