



# PLANETARY GEARHEAD

TRIDENT ENGINEERING LIMITED  
 Trident House, King Street Lane,  
 Winnersh, Wokingham,  
 Berkshire, RG41 5AS

Telephone: 0118 978 6444  
 Fax: 0118 977 6345  
 Email: sales@tridenteng.co.uk  
 www.tridenteng.co.uk

GP62.\_ \_ \_ \_

Technical Data					Product combinations				
Planetary gearhead			straight teeth		M 14433				
Output shaft			hardened		M 14437				
Internal gear			case hardened, zincplated, blackchrome						
Bearing at output			ball bearing						
Radial play, 7 mm from flange			max. 0.08	mm					
Axial play			max. 1	mm					
Max. permissible axial load			120	N					
Max. permissible force for press fits			1000	N					
Average backlash no load per stage			<0.9	°					
Recommended input speed			<4000	rpm					
Recommended temperature range			-20/+80	°C					

Gearhead Order No	Ratio Reduction	Number of stages	Maximum torque continuous [Nm]	Maximum torque intermittent [Nm]	Sense of Direction	Max permissible Radial load 24mm from flange N	Max Efficiency [%]	Weight [g]	L1 [mm]
GP62.0005	5.2:1	1	8	12	=	240	80	950	72.60
GP62.0019	19.2:1	2	25	37.5	=	360	75	1250	88.40
GP62.0027	27:1	2	25	37.5	=	360	75	1250	88.40
GP62.0035	35:1	2	25	37.5	=	360	75	1250	88.40
GP62.0071	71:1	3	50	75	=	570	70	1540	104.30
GP62.0100	100:1	3	50	75	=	570	70	1540	104.30
GP62.0139	139:1	3	50	75	=	570	70	1540	104.30
GP62.0181	181:1	3	50	75	=	570	70	1540	104.30
GP62.0236	236:1	3	50	75	=	570	70	1540	104.30

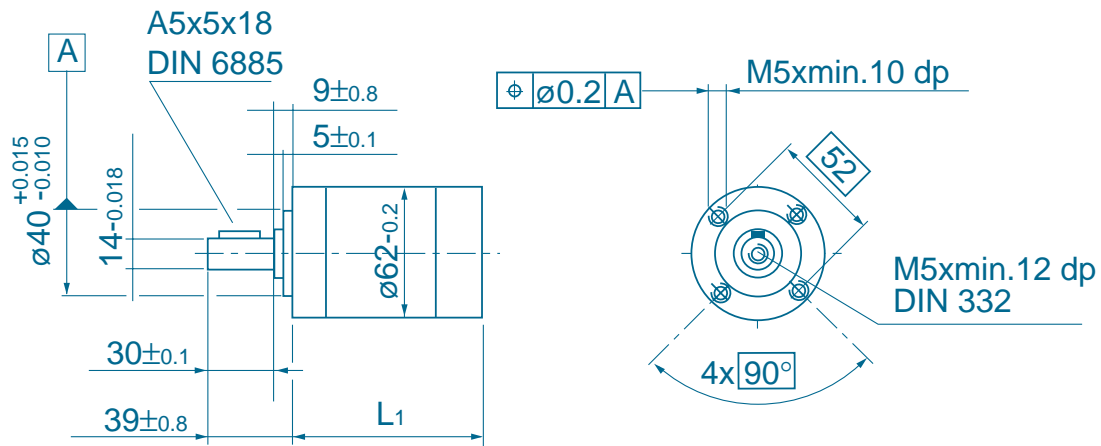

**Notes**