

# DC Motors

## DN12 series

- Smooth rotation, low noise & low vibration
- 2 motor lengths enabling versatility
- Matching gear heads available as options

### Representative applications

- Motorized actuators
- Camera auto focusing
- Film winding for cameras

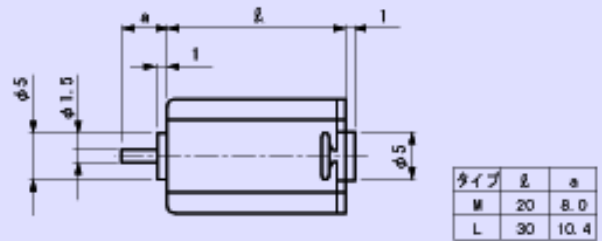
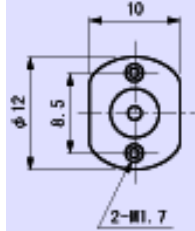
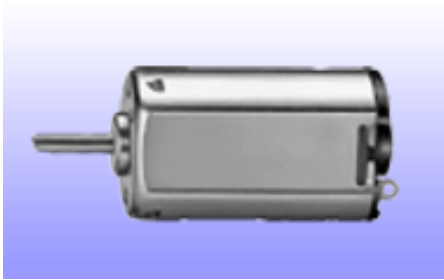

DN12 M type

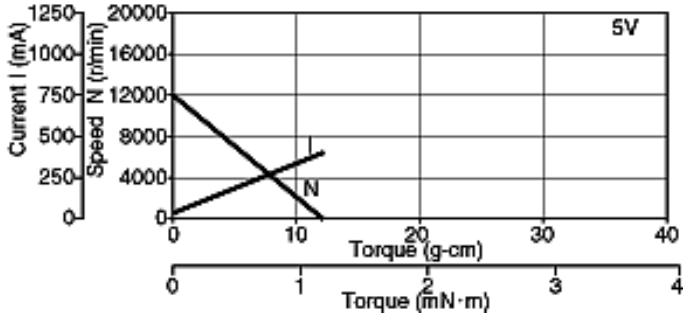

DN12 L type

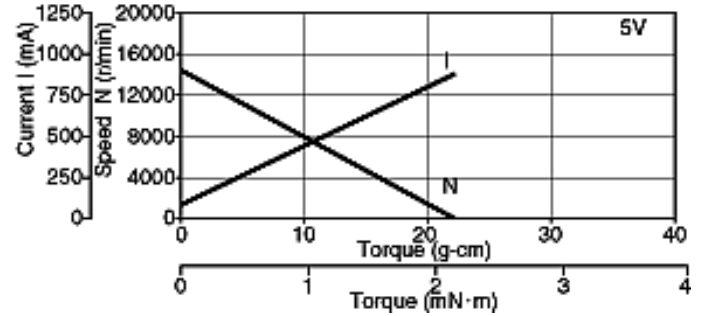

			DN12 M type	DN12 L type
Voltage		V	5	5
R a t e d	Power output	W	0.3	0.9
	Torque	mN·m	0.29	0.98
		g-cm	3	10
	Speed	r/min	9,000	8,700
Current		mA	145	450
N o l o a d	Speed	r/min	12,000	15,000
	Current	mA	60	90
Starting torque		mN·m	1.18	2.16
		g-cm	12	22
Torque constant		mN·m/A	3.33	2.75
		g-cm/A	34	28