

DC Motors

DN35 series

- High power output, low mechanical/electrical noise, long life
- 2 motor lengths enabling versatility
- Matching gear heads & encoders available as options

Representative applications

- Transport mechanism for cards or bills
- Vending machine product advance mechanism
- Paper handling mechanism for printers

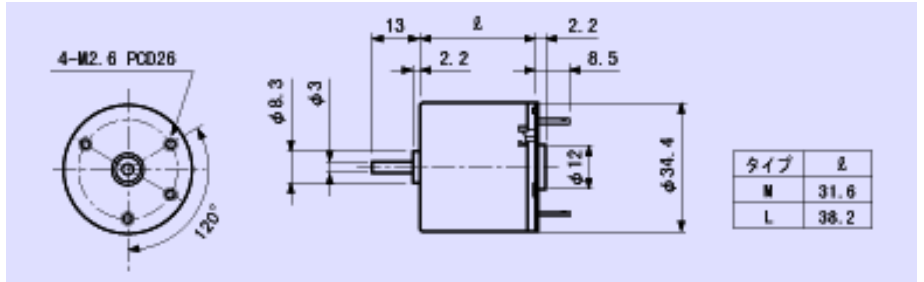
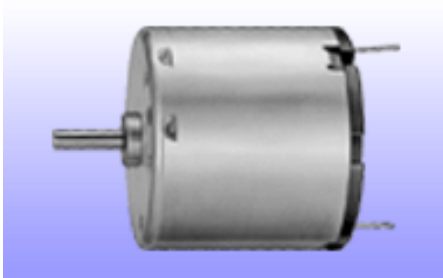

DN35 M type

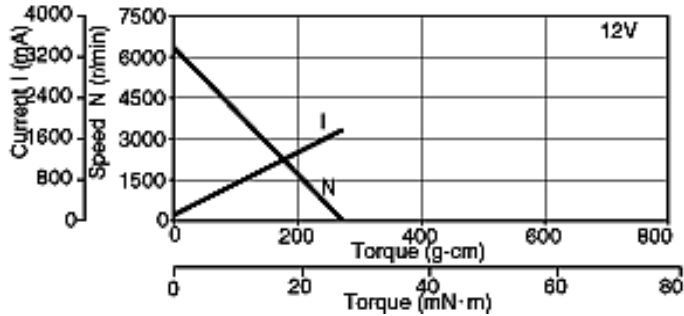

DN35 L type

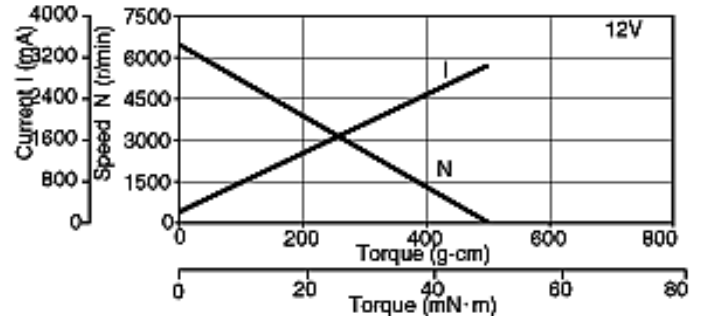

			DN35 M type		DN35 L type	
Voltage		V	12	24	12	24
R a t e d	Power output	W	2.3	2.3	4.5	4.5
	Torque	mN·m	3.92	3.92	7.85	7.85
		g-cm	40	40	80	80
	Speed	r/min	5,600	5,500	5,500	5,500
Current	mA	330	165	560	300	
N o l o a d	Speed	r/min	6,500	6,500	6,550	6,500
	Current	mA	90	45	90	60
Starting torque		mN·m	28.4	25.5	49.0	49.0
		g-cm	290	260	500	500
Torque constant		mN·m/A	16.0	35.8	17.0	33.1
		g-cm/A	163	365	173	338