

# DC Motors

## EN35 series

- 5-slot armature for low cogging
- High power output, low mechanical/electrical noise, long life
- Matching gear heads & encoders available as options

### Representative applications

- Transport mechanism for cards or bills
- Vending machine product advance mechanism
- Paper handling mechanism for printers

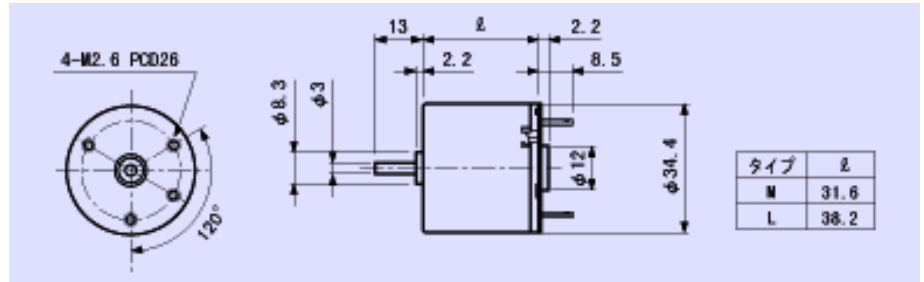
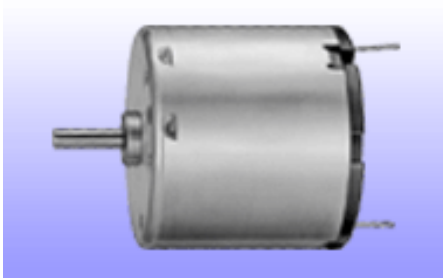

### EN35 M type

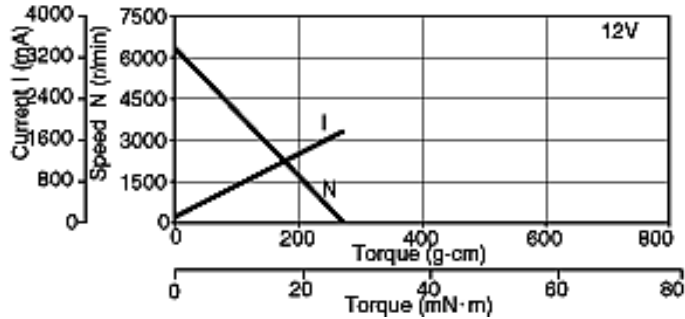

### EN35 L type

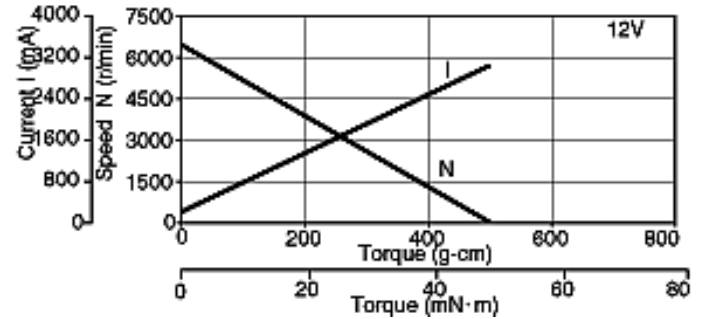

		EN35 M type		EN35 L type		
Voltage		V	12	24	12	24
R a t e d	Power output	W	2.3	2.5	4.5	4.5
	Torque	mN·m	3.92	3.92	7.85	7.85
		g-cm	40	40	80	80
	Speed	r/min	5,700	6,000	5,500	5,500
Current	mA	340	175	550	275	
N o l o a d	Speed	r/min	6,500	6,900	6,600	6,600
	Current	mA	95	50	95	45
Starting torque	mN·m	31.4	29.4	46.1	49.0	
	g-cm	320	300	470	500	
Torque constant	mN·m/A	16.1	30.8	17.1	33.7	
	g-cm/A	164	314	174	344	