

Stepper Motor 28SH45 High Torque Hybrid

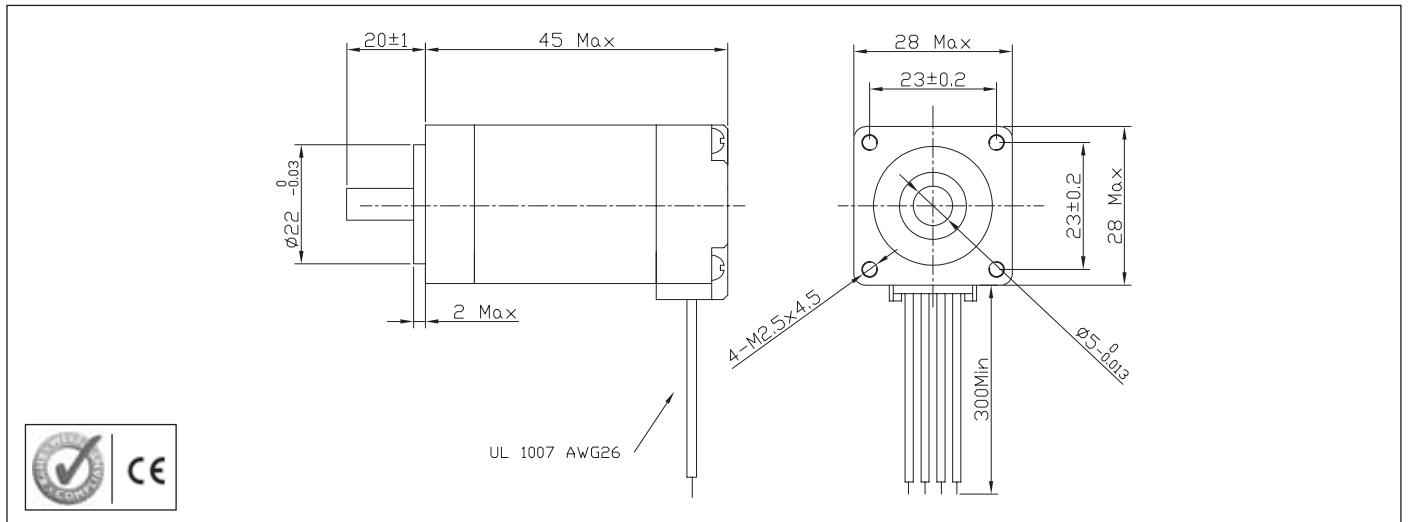

Characteristics

STEP ANGLE
1,8°

STEP ANGLE ACCURACY
± 5%

INSULATION CLASS
B

AMBIENT TEMPERATURE
-20°C +50°C

TEMP. RISE
80°C MAX (RATED CURRENT, 2 PHASE ON)

INSULATION RESISTANCE
100 M OHM MIN. 500 VDC

DIELECTRIC STRENGTH
500 VAC FOR ONE MINUTE

SHAFT RADIAL PLAY
0,02 MAX (450 G LOAD)

SHAFT AXIAL PLAY
0,08 MAX. (450 G LOAD)

MAX RADIAL FORCE
28 N (20 MM FROM FRONT FLANGE)

MAX AXIAL FORCE
10 N

Specification

Model		28SH45-0956A	28SH45-0674A
1	RATED VOLTAGE V	3,4	4,56
2	CURRENT/PHASE A	0,95	0,67
3	RESISTANCE/PHASE Ω	3,4	6,8
4	INDUCTANCE/PHASE MH	1,2	4,9
5	HOLDING TORQUE Nm	0,075	0,095
6	ROTOR INERTIA G-CM²	12	12
7	WEIGHT Kg	0,14	0,14
8	NUMBER OF LEADS N°	6	4

Speed vs. Torque Characteristics

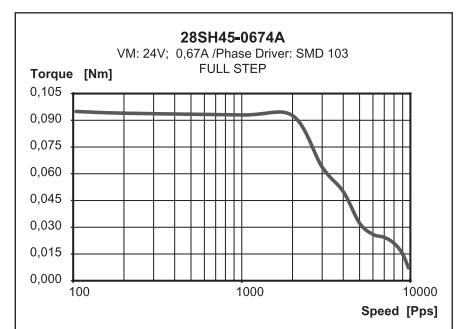
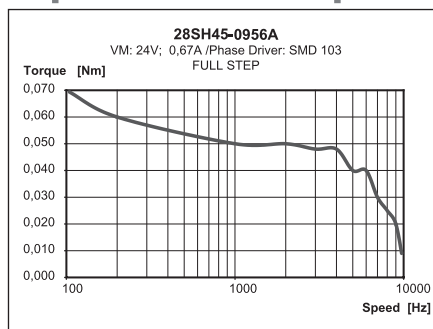

Connection

LEAD N°	COLOR	GAUGE	FUNCTION
1	BLACK	UL1430 AWG26	PHASE A
2	GREEN	UL1430 AWG26	PHASE A-
3	RED	UL1430 AWG26	PHASE B
4	BLUE	UL1430 AWG26	PHASE B-
UNIPOLAR MOTOR			
5	YELLOW	UL1430 AWG26	COM PHASE A
6	WHITE	UL1430 AWG26	COM PHASE B